

Cor-3500 C16 System with thermal break

A hinged 16 mm Groove system that optimizes labour and saves on the installation time of each window making it possible to fit the sash and frame opening kits in only 5 minutes.



Cor-3500 C16 System with thermal break

Transmittance

U_w from 1,2 (W/m²K)

Please consult typology, dimensions and glass

Acoustic insulation

Maximum glazing: 34 mm.

Maximum acoustic insulation **R_w=46 dBA**

Finishes

Possibility of dual colour

Colour powder coating (RAL, mottled and rough)

Wood effect powder coating

Anti-bacterial powder coating

Anodized

Categories achieved at test centre

Air permeability
(EN 12207:2000): Class 4

Water tightness
(EN 12208:2000): Class 9A

Wind resistance
(EN 12210:2000): Class C4
Reference test 1,23 x 1,48 m. 2 sashes



Sections

Frame 54 mm.
Sash 62 mm.

Profile thickness

Window 1,5 mm.
Door 1,7 mm

Polyamide strip length 24 mm.

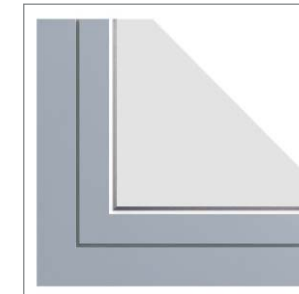
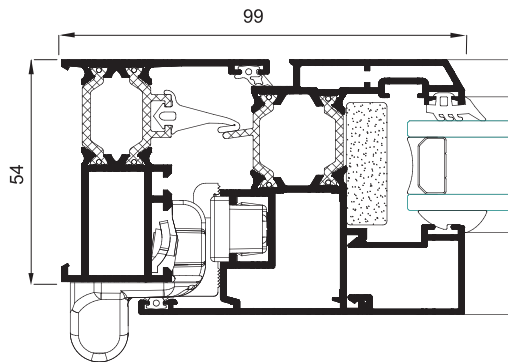

Opening possibilities

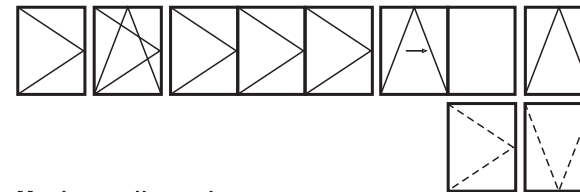

Open in: practicable, turn-tilt, folding, parallel tilt, hinged.

Open out: practicable, projecting-sliding.

Maximum dimensions

Width (L) = 1.600 mm.
Height (H) = 2.600 mm.
Single sash window, turn-tilt

Maximum weight/sash

120 Kg.

Please consult regarding maximum weight and dimensions for other opening types