

Cor-60 CC16 system with thermal break

A hinged 60 mm window system with a transmission value from only $1,0 \text{ W/m}^2\text{K}$ that is achieved thanks to the perfect union and design of aluminium profiles, tubular 25 mm polyamide rods, E.P.D.M water tightness gaskets and a polyolefine foam fitted around the glazing space perimeter.

There is also the possibility of straight and chamfered sashes and for straight, chamfered and curved beads.

Allows for the possibility of incorporating hardware with concealed hinges.



Cor-60 CC16 system with thermal break

Transmittance

Uw from 1,0 (W/m²K)

Please consult typology, dimensions and glass

Acoustic insulation

Maximum glazing: 48 mm.

Maximum acoustic insulation **Rw=46 dBA**

Finishes

Possibility of dual colour

Colour powder coating (RAL, mottled and rough)

Wood effect powder coating

Anti-bacterial powder coating

Anodized

Categories achieved at test centre

Air permeability
(EN 12207:2000): Class 4

Water tightness
(EN 12208:2000): Class E1200

Wind resistance
(EN 12210:2000): Class C5
Reference test 1,31 x 1,48 m. 2 sashes



Sections

Frame 60 mm.
Sash 70 mm.

Profile thickness

Window 1,5 mm.
Door 1,7 mm.

Polyamide strip length 25 mm.

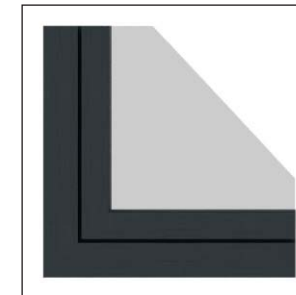
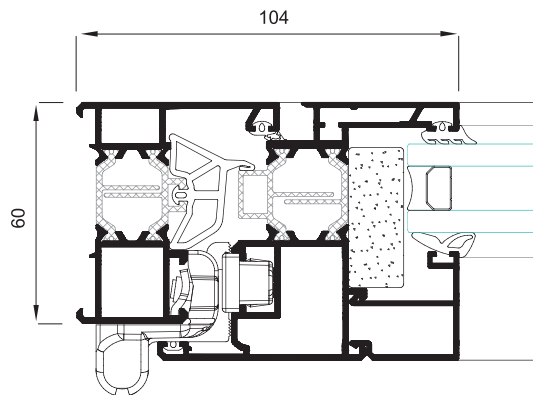

Opening possibilities

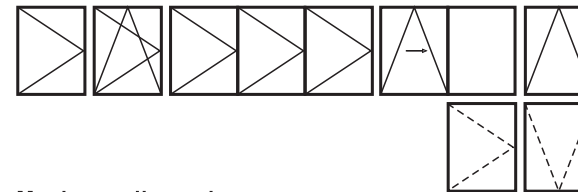

Open in: practicable, turn-tilt, folding, parallel tilt, hinged.

Open out: practicable, projecting-sliding.

Maximum dimensions

Width (L) = 1.600 mm.
Height (H) = 2.800 mm.
Single sash window, turn-tilt

Maximum weight/sash

150 Kg.

Please consult regarding maximum weight and dimensions for other opening types